



## The 2007 South Carolina Web Accessibility Conference

### Instructions for Conference Attendees

#### *Items to bring with you*

- Notepad
- Pen / Pencil (Your Choice)
- The facility has Wi-Fi so feel free to bring your compatible devices.
- **Bring your business cards!** You will need them to register for door prizes and you may also want to share them with all your new friends. If you do not have a business card, blank cards will be available to fill out.

#### *Parking*

Unfortunately, the new parking garage for the Convention Center is still under construction, which makes parking for the event a slight challenge for us again this year. The small lot next to the Columbia Metropolitan Convention Center will be used by the nearly 700 attending the Assistive Technology Expo. **Please do not park in this lot.** Many of the attendees of the Expo have disabilities and will need these spaces.

Your parking options are as follows:

- SCDOT Auxiliary Parking Lot located on Greene Street between Park Street and Lincoln. It is directly behind the Carolina Coliseum and in front of the Colonial Center. **Spaces here are limited to first come first served.** You will be two blocks away from the Convention Center.
- Overflow lot located on Devine between Lincoln and Huger streets next to the rail road tracks. A shuttle will be provided to the Convention Center from this lot.
- Parking lot located at the Capital City Baseball Stadium on Assembly Street. Shuttle service is provided from this lot as well.

**NOTE: If you have others coming from your office, carpooling would be a great idea. Also, if you work in the surrounding area, consider walking or having someone from your office drop you off.**

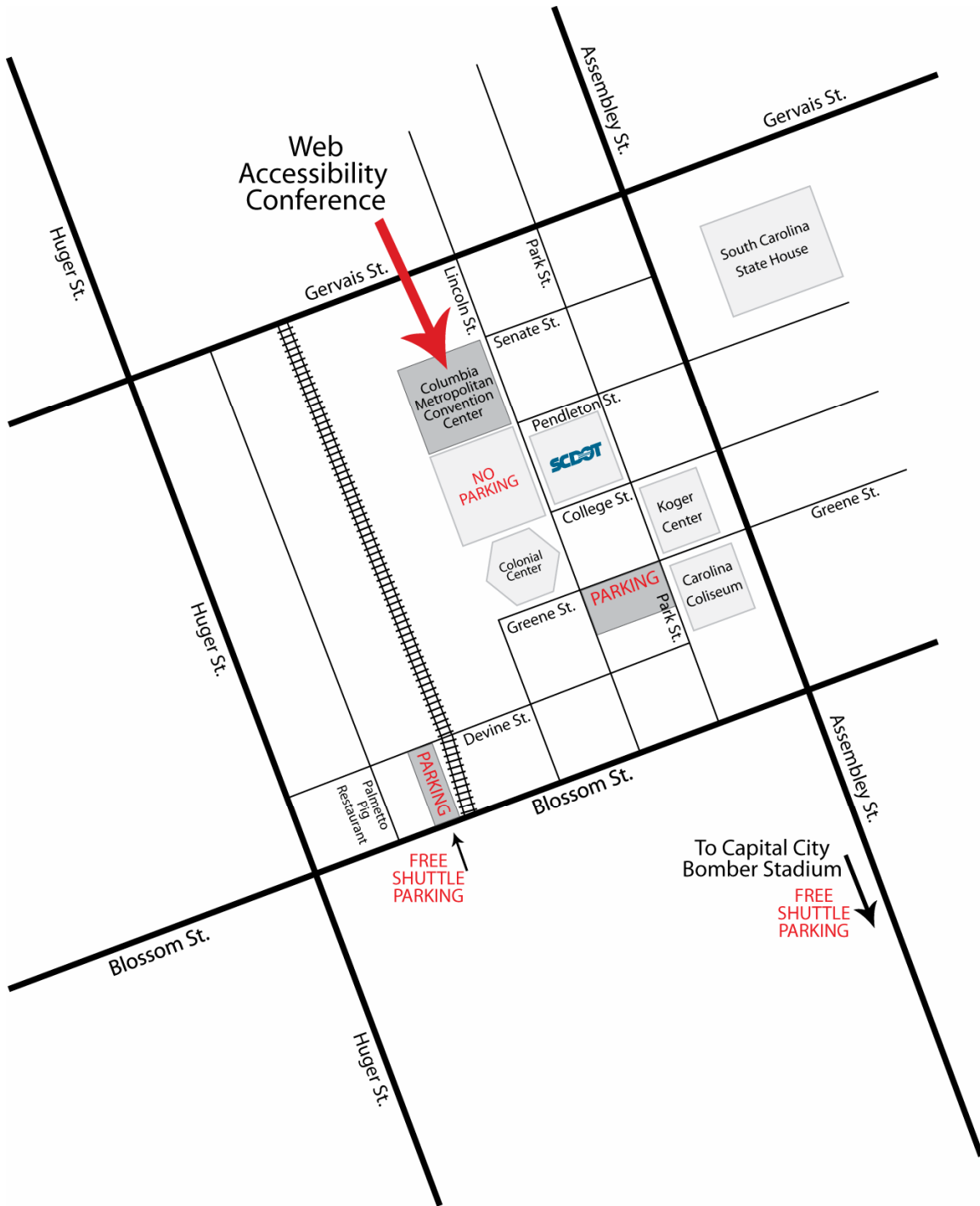
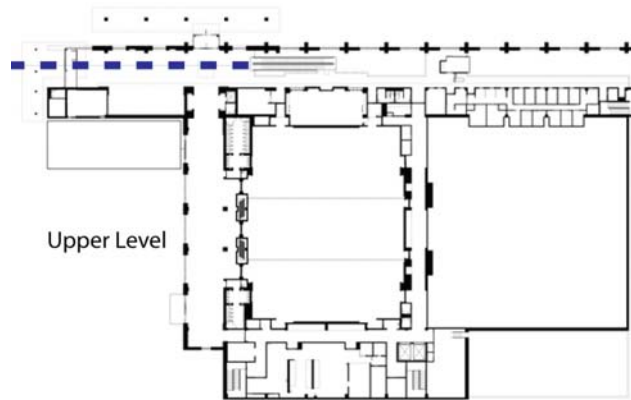

Figure 1 Parking Map

## ***Where to go once you arrive***

The registration table for the Web Conference is not located at the Expo Registration booth. Please go directly to Richland B and C rooms.

If you enter from the main entrance on the upper level, just take the escalator downstairs and follow the signs to the Web Accessibility Conference. You can also enter on the lower level from the parking lot next to the building.



**Figure 2 Upper Level of Convention Center**

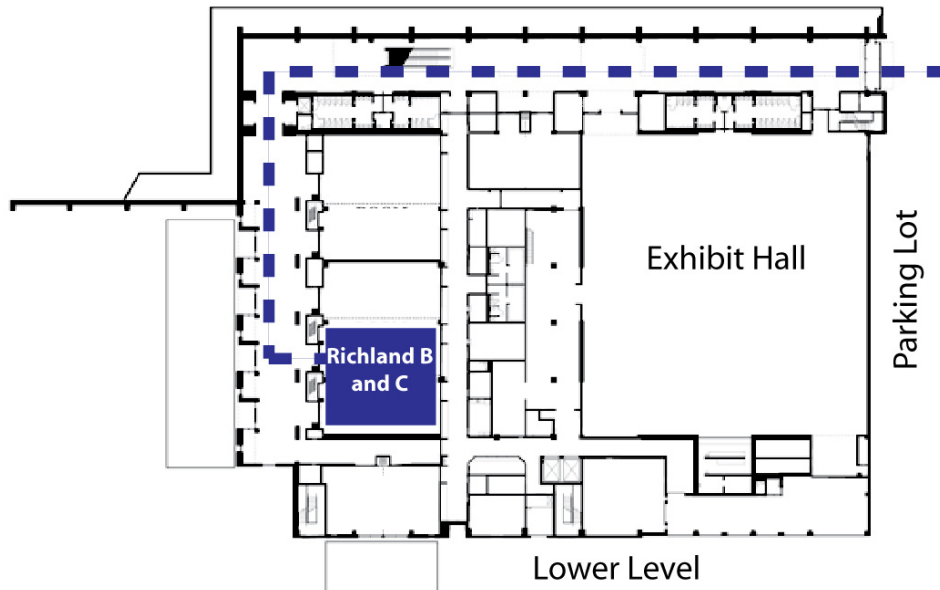

**Figure 3 Lower Level of Convention Center**

## ***Food***

### **Snacks**

A concession stand, located in the back of the AT Expo Exhibit Hall, will open at 8:30 a.m. The following items will be available for purchase:

- Pastries
- Coffee
- Soft Drinks
- Dry snacks
- Bottled water

### **Lunch**

During lunch, the concession stand will have these additional items for purchase:

- Pizza
- Sandwiches
- Fresh Salads

### **Lunch in the Vista**

You may decide to enjoy one of the local restaurants in Columbia's popular Congaree Vista. Here is a listing of restaurants in the area.

<http://www.vistacolumbia.com/maincategory.asp?Search=Dining>