

# **“You Can Do It – We Can Help!”**

## **The South Carolina Web Accessibility Conference**

### **Instructions for Conference Attendees**

#### ***Items to bring with you***

- Notepad
- Pen / Pencil (Your Choice)
- The facility has Wi-Fi so feel free to bring your compatible devices.
- **Bring your business cards!** You will need them to register for door prizes and you may also want to share them with all your new friends. If you do not have a business card, blank cards will be available to fill out.

#### ***Parking***

The parking lot for the Columbia Metropolitan Convention Center will be used by the nearly 700 attending the Assistive Technology Expo. **Please do not park in this lot.** Many of the attendees of the Expo have disabilities and will need these spaces.

The SC Department of Transportation has graciously donated parking spaces to the SC Web Accessibility Conference attendees. The parking lot is located directly behind the Koger Center and in front of the Colonial Center. You will be just a short walk from the Convention Center.

There will be traffic cones setup in SCDOT's parking lot to separate the parking for SCDOT employees and the parking for conference attendees. **Please park in the spaces closest to Greene Street.**

In the event that this lot is filled, there is another lot located on Devine between Lincoln and Huger streets next to the rail road tracks. A shuttle will be provided to bring attendees to the Convention Center.

NOTE: If you have others coming from your office, carpooling would be a great idea. Also, if you work in the surrounding area, consider walking or have someone from your office drop you off.

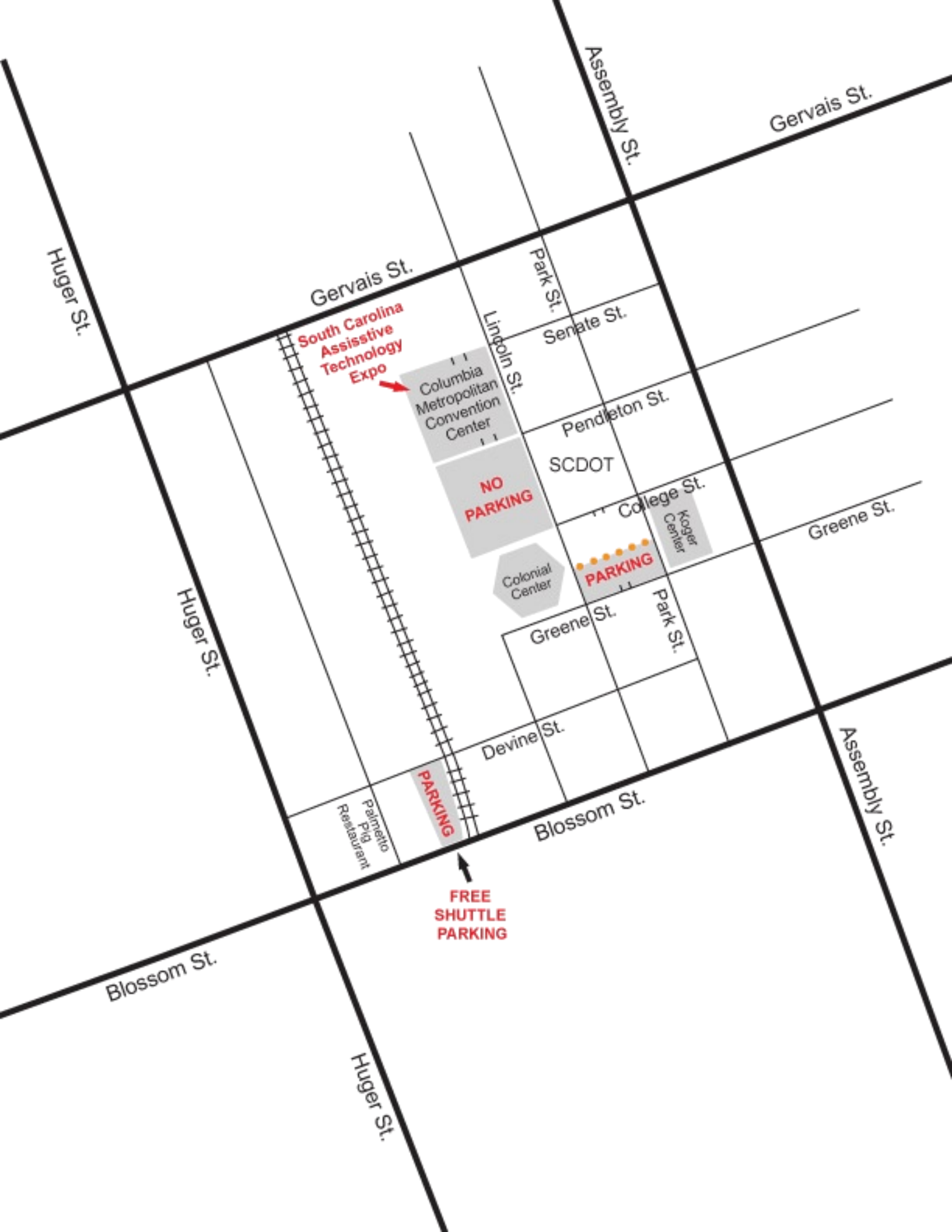

Huger St.

Assembly St.

Gervais St.

Gervais St.

Park St.

Lincoln St.

Senate St.

South Carolina Assistive Technology Expo

Columbia Metropolitan Convention Center

Pendleton St.

NO PARKING

SCDOT

College St.

Kooger Center

Greene St.

Colonial Center

PARKING

Greene St.

Park St.

Huger St.

Devine St.

Blossom St.

Palmetto Pig Restaurant

PARKING

FREE SHUTTLE PARKING

Blossom St.

Huger St.

Assembly St.

## ***Where to go once you arrive***

Our meeting will be on the lower level of the Columbia Metropolitan Convention Center in Richland B and C.

If you enter from the main entrance on the upper level, just take the escalator downstairs and follow the signs to Richland. You can also enter on the lower level from the parking lot next to the building.

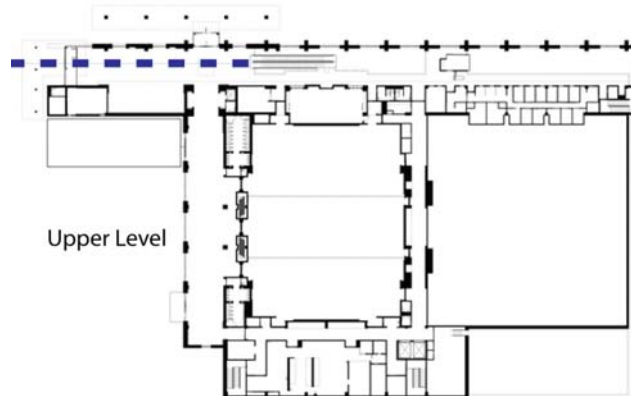

**Figure 2 Upper Level of Convention Center**

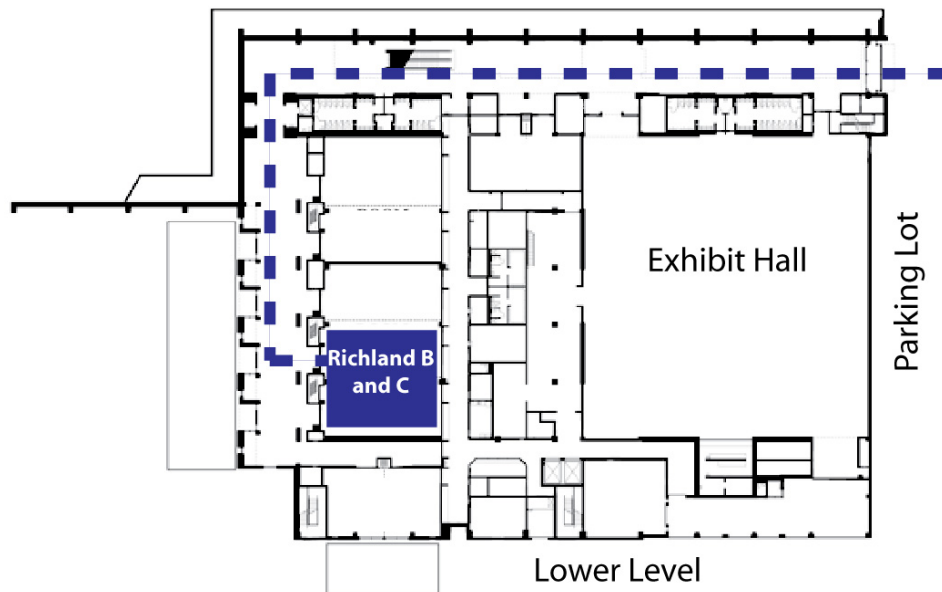

**Figure 3 Lower Level of Convention Center**

## **Food**

### **Snacks**

A concession stand, located in the back of the AT Expo Exhibit Hall, will open at 8:30 a.m. The following items will be available for purchase:

- Pastries
- Coffee
- Soft Drinks
- Dry snacks
- Bottled water

### **Lunch**

During lunch, the concession stand will have these additional items for purchase:

- Hamburgers
- Cheeseburgers
- Hotdogs
- French Fries
- Salads
- Candy Bars

### **Lunch in the Vista**

You may decide to enjoy one of the local restaurants in Columbia's popular Congaree Vista. Here is a listing of restaurants in the area.

<http://www.vistacolumbia.com/maincategory.asp?Search=Dining>